

# Measuring Guidelines

When measuring a kitchen for countertops, you may either measure the cabinets or existing countertops. Always measure the "Outside" dimensions (from back corner of the cabinets or existing top to the other back corner). Being consistent when measuring all sections helps to reduce any confusion when the pieces are ordered. Diagonal corners and overhangs will require measurements of the countertop and the cabinets in certain areas. Note all appliance locations and exposed countertop ends to ensure that proper end treatments are ordered. Standard countertops usually overhang the front edge of cabinets by 1-1/4" to 1-1/2". Our tops are manufactured to give a 1-5/16" front overhang to standard kitchen and vanity cabinets.

## Key

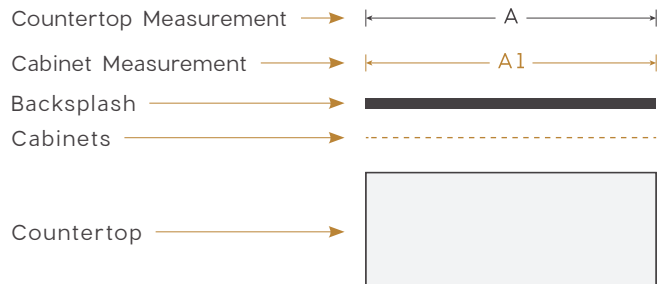

## Straight Countertop / Island / Vanity Top

Allow for overhangs on any exposed ends. If measuring cabinets, note any overhangs on exposed ends.

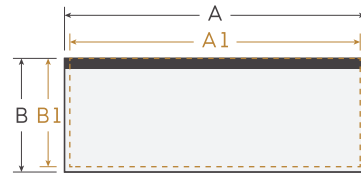

## Corner Countertop Section

Whenever two pieces of countertop join together, a miter or seam will be necessary (joints may be a 45°, a j-miter or a seamless corner). If you are making dimension changes from existing countertops to new countertops, be sure to consider space needed to accommodate any extra length or width added.

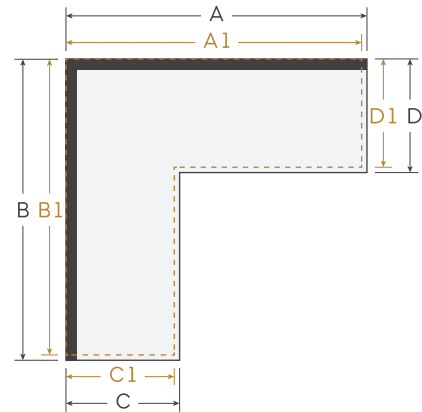

## Diagonal Corner Countertop

Diagonal corner cabinet layouts require the cabinet face frame measurement (E) along with our overall countertop dimensions. With a standard front overhang of 1-5/16" the D measurements is 7/8" less than the face frame of the cabinet. This particular corner style is a traditional corner. Depending on the angle of the diagonal corner, an additional section in the back corner may be necessary to complete the countertop.

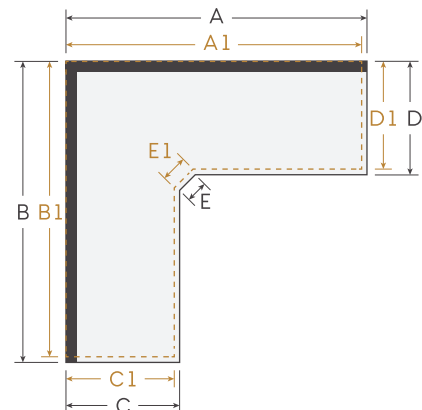

## 90° Corner To Peninsula / Corner To Peninsula

Backsplash will end where the back corner of your cabinet ends.

Gold line represents cabinets. Take care when measuring this portion of the layout. Be sure to provide us with the dimension of your cabinets in this instance. This ensures that the countertop joining the peninsula will be cut to the proper length.

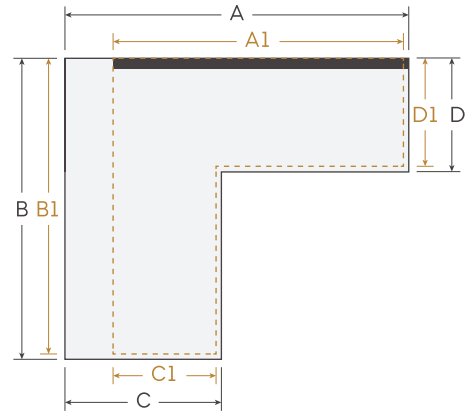

## Dual 45° Corner Countertop with Peninsula

Backsplash will end where the back corner of your cabinet ends. Requires loose backsplash on laminate, backsplash can end at any point due to being loose on all three materials.

Gold line represents cabinets. Take care when measuring this portion of layout. Be sure to provide us with the dimensions of your cabinets in this instance. This ensures that the countertop joining the peninsula will be cut to the proper length. Depending on the angle of the diagonal corner, an additional section in the back corner may be necessary to complete the countertop.

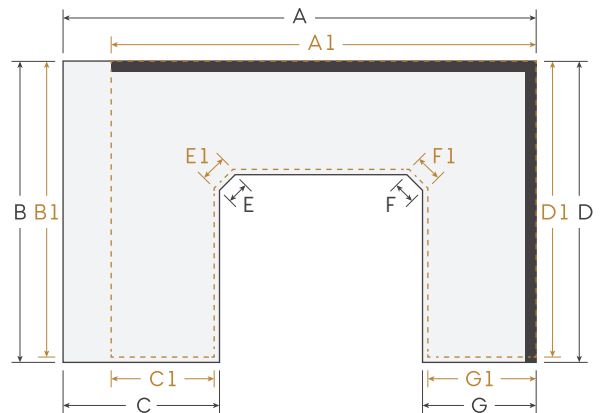

## How To Measure Your Sink

Sink cutouts require the measurement from the right-most end of the piece containing the sink hole to the center of the plumbing or sink base (A2). Sink cutouts size is needed. Note the sku, brand, and model number of the sink you will be installing. Handmade/hammered sinks will require additional measurements before cutting, as each sink can vary slightly.

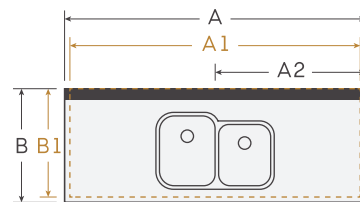

## How To Measure Your Drop-in Appliance

Drop-in appliances require the measurement from the right-most end of the countertop to the center of the appliance (A2). Appliance cutouts size is needed. Note the sku, brand, and model number of the appliance you will be installing.

