



CUSTOMCRAFT®
COUNTERTOPS

Quartz Light Cure Acrylic Repair Kit

Directions

1. Clean the damaged area and surrounding space so it is free from dust and dirt. Use the included alcohol prep pad to remove any oils or contaminants. Make sure the area is completely dry before proceeding to step 2. (Fig 1)
2. Place the applicator tip on the Light Cure Acrylic™ syringe and apply a small amount of repair acrylic in the damaged area. For best results, do not overfill. Make the repairs in small sections, no larger than 1/4" or 6mm. Deeper damages will require curing in layers. (Fig 2)
3. Place the included curing strip on the uncured acrylic. Using the provided wooden stick, gently touch the top of the curing strip to help push the repair material into the damaged area. If the damaged area is larger than a curing strip, you can use clear packing tape, folded sticky side to sticky side. Packing tape is also helpful when repairing an edge, used as a retaining wall to hold the repair material in place. (Fig 3)
4. Activate the constant on switch on the LED light and use the LED light stand to hold and focus the blue light above the curing strip. Exposure duration will depend on the size of the damage, but it is safe to start with 5–7 minutes. Before removing the curing strip, use the provided wooden stick to test for hardness. Additional LED exposure may be needed, especially for larger damages. (Fig 4)
5. Remove the curing strip and verify the repair is completely cured. If the repair remains tacky add additional LED exposure. If the repair is uneven, use rubbing alcohol to gently wipe the repaired surface. Then use the provided 220 grit sand paper to remove any overfilled material and make the repair level with the surrounding area. Rub in gentle circles. Then for increase shine, use the included 2000 grit wet sanding paper with a dab of water. Hazing or scratching may occur if you are too aggressive. (Fig 5)
6. Gently apply a few drops of polishing paste on the repaired area to wipe away dust while polishing the repaired area for maximum shine. (Fig 6)

Light Cure Acrylic Repair Kit

Alcohol Prep Pad

Acrylic Syringe

Applicator Tip

Curing Strip

Wooden Stick

LED Light

LED Light Stand

Sand Paper

Polishing Paste

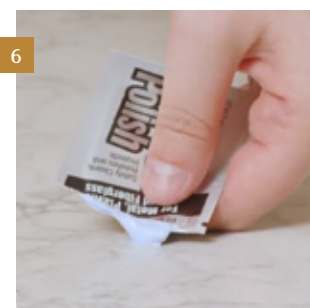
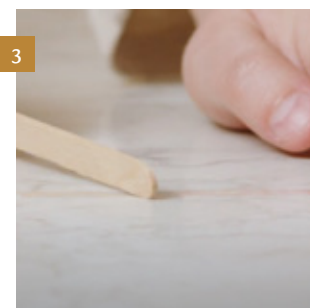
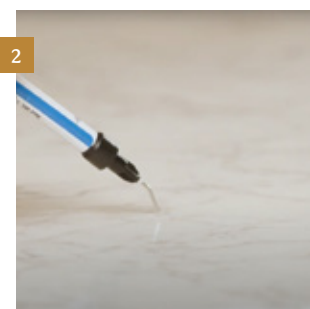
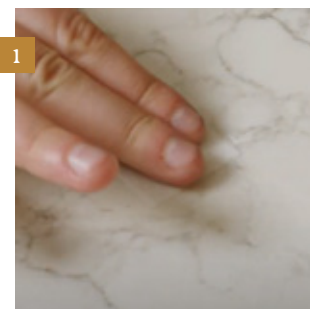

NOTE: It is important to follow each step to ensure an efficient repair and optimal results. If tackiness remains after full curing duration, wipe with rubbing alcohol then sand and polish as directed. We recommend storing syringes with microtips installed – gently pull back on the plunger to pull the repair material inside the syringe body. LCA™ has a shelf life of 18 months.